

Model shown is left hand motor

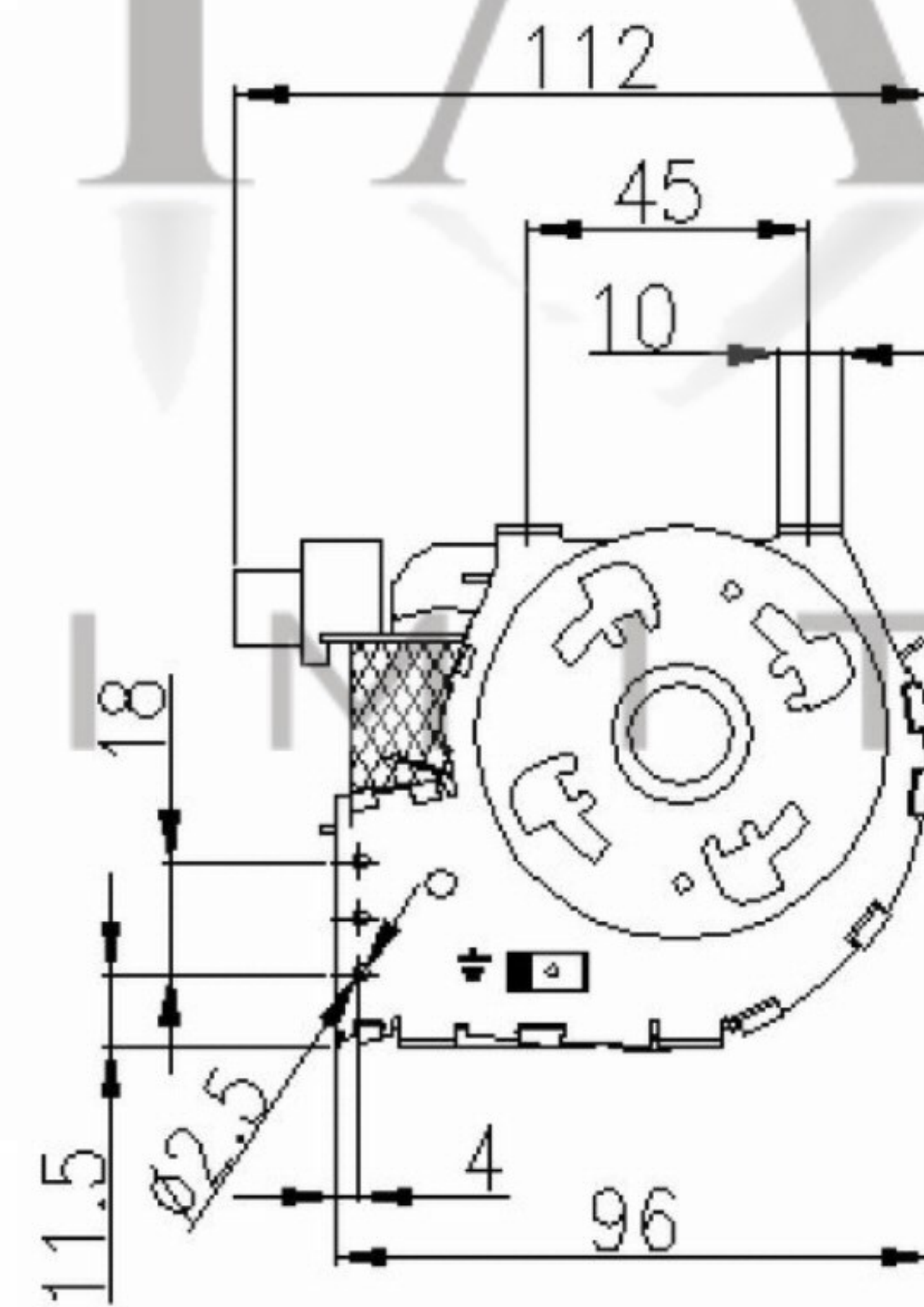

Fan Motor Mounting Positions

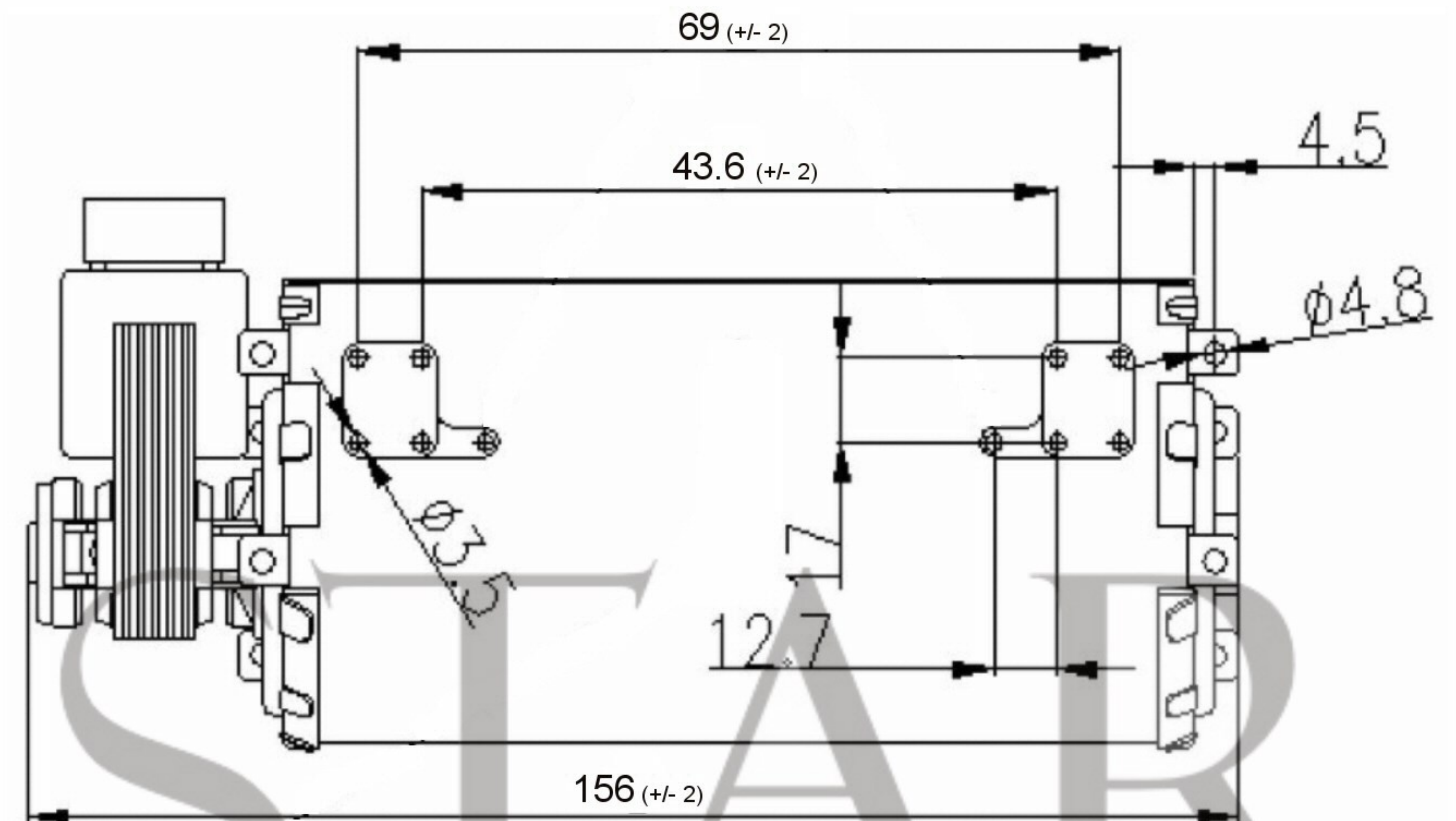
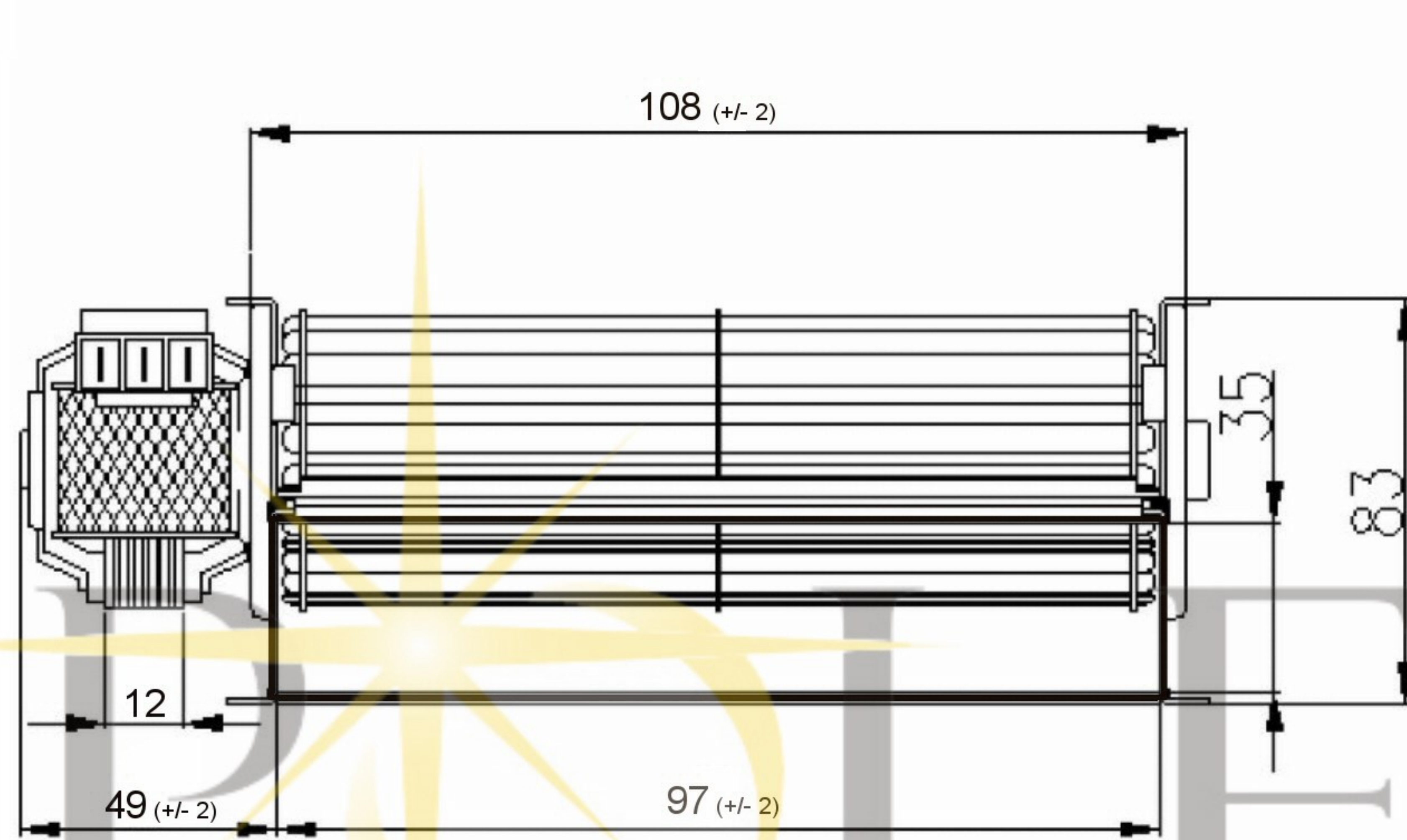
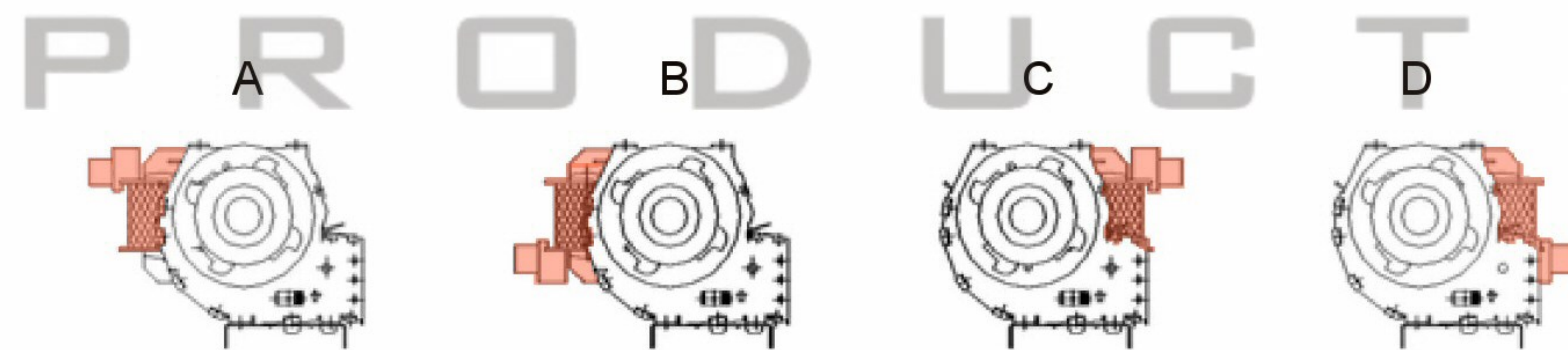

SPECIFICATION		Temp. Range: 0°C to + 60°C			
Motor	SP	Speed (RPM)	2030	Bearings	Sleeve
Voltage (V)	230/240	Motor Protection	Imp. Prot.	Weight (Kg)	0.8
Frequency (Hz)	50	Insulation Class	F	Air Volume (M³/h)	70
Power In/Out (W)	18	Protection Class	IP20	Noise Level (dBA)	
Current (A)		Capacitor (Mf)	N/A	Max Pressure (Pa)	60

POLE STAR
PRODUCTS LIMITED

POLE STAR PRODUCTS LIMITED	
Product Code	TAS09-12
Projection Angle	± 3°
	A4
	Scale: Sheet: 1 of