

Model shown is right hand motor

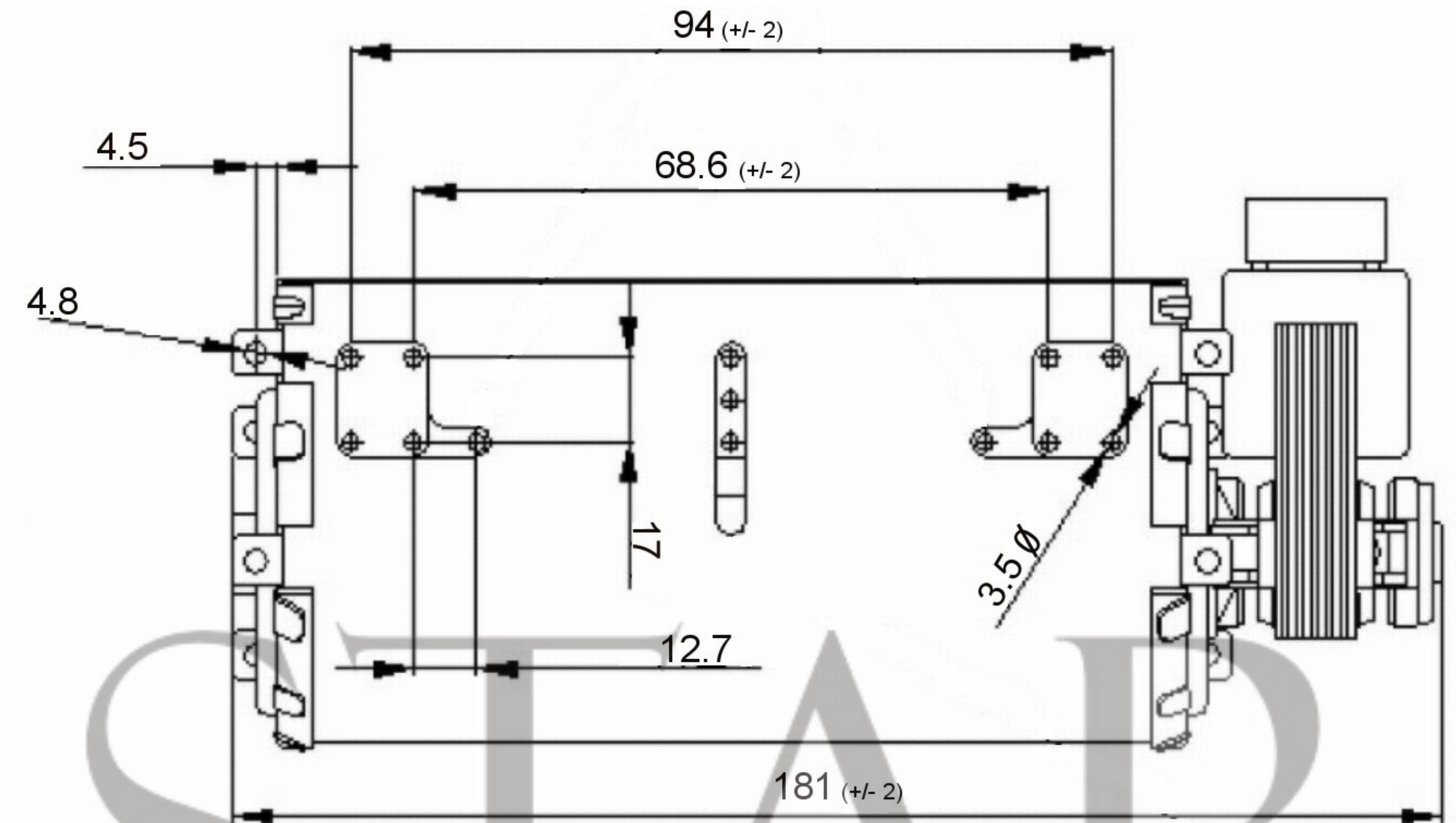

Fan Motor Mounting Positions

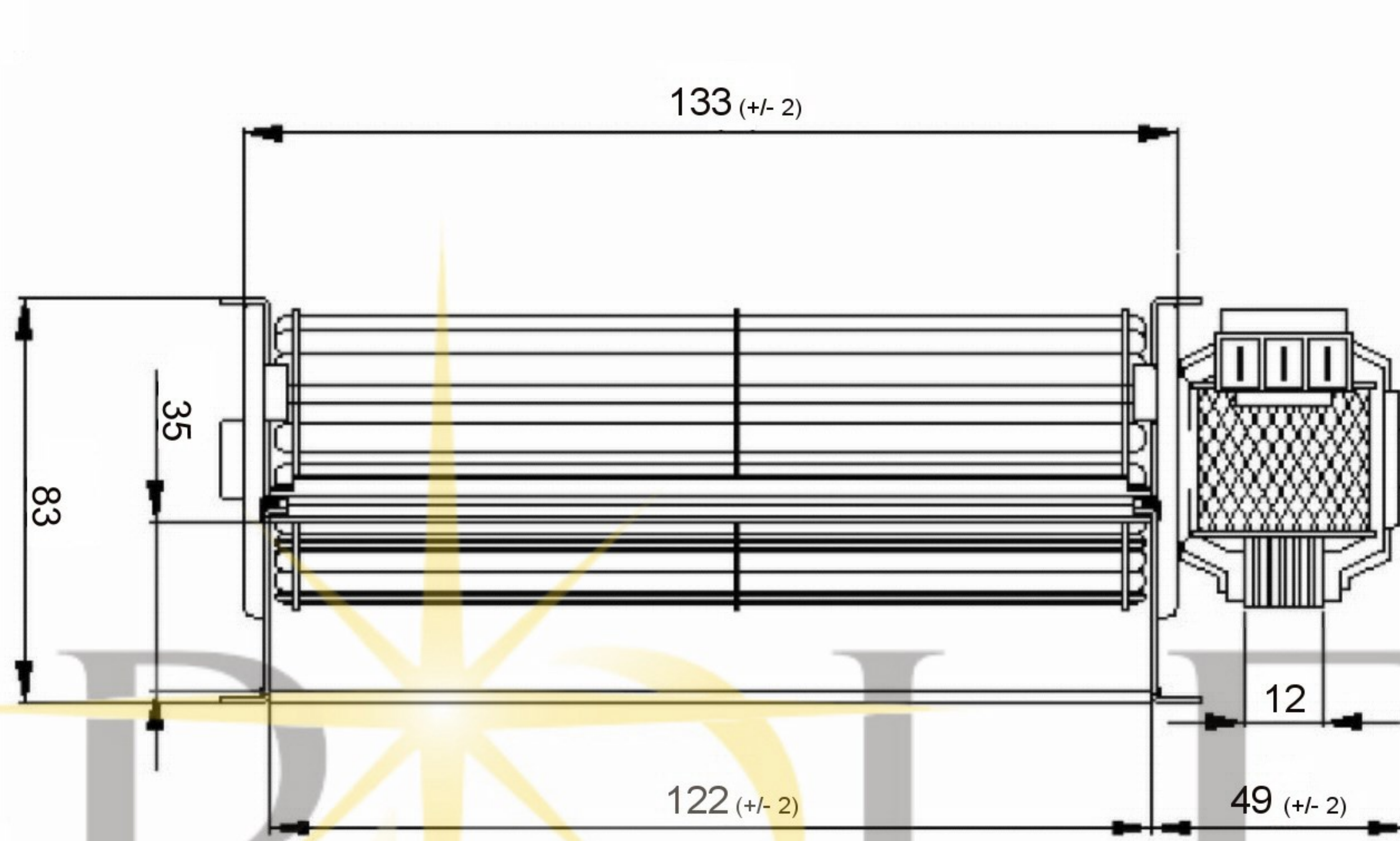
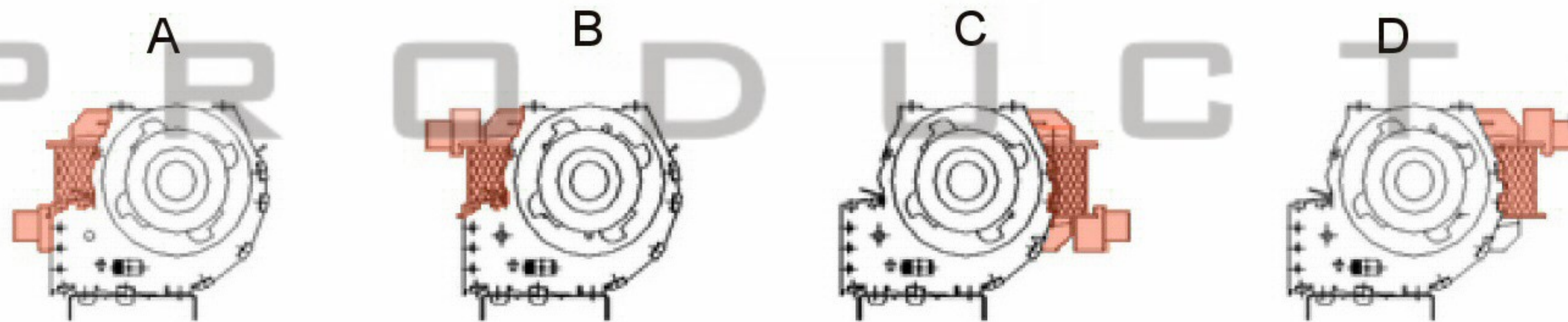

SPECIFICATION	Temp. Range: 0°c to + 60°c				
Motor	SHP	Speed (RPM)	1600	Bearings	Sleeve
Voltage (V)	230/240	Motor Protection	Imp.Prot	Weight (Kg)	0.8
Frequency (Hz)	50	Insulation Class	F	Air Volume (M³/h)	85
Power In/Out (W)	19	Protection Class	IP20	Noise Level (dBA)	
Current (A)		Capacitor (Mf)	N/A	Max Pressure (Pa)	57

POLE STAR
PRODUCTS LIMITED

POLE STAR PRODUCTS LIMITED	
Product Code	TAS12-12 (R)
Projection Angle	± 3°
	A4
Scale:	Sheet: 1 of