

Model shown is left hand motor

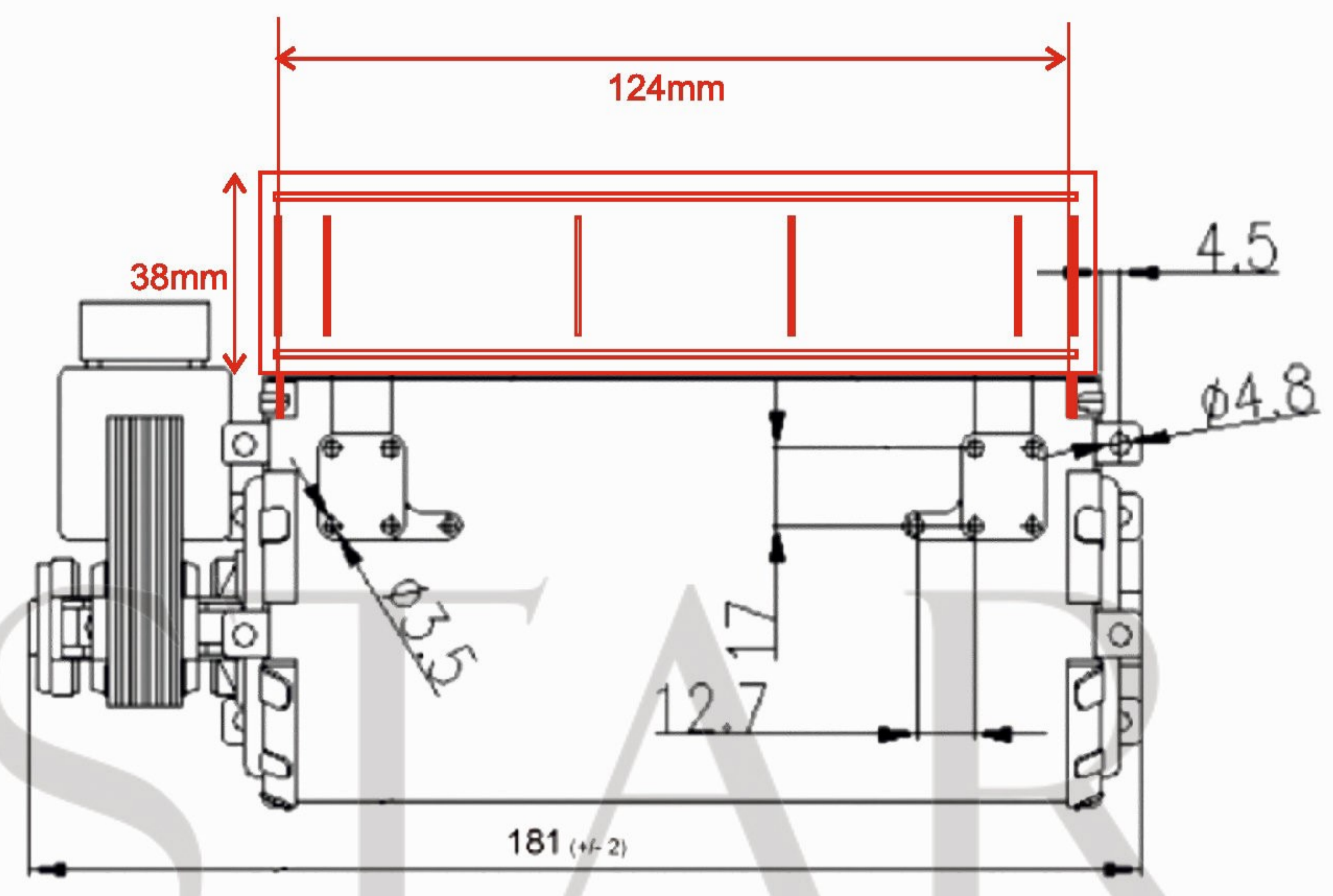

Fan Motor Mounting Positions

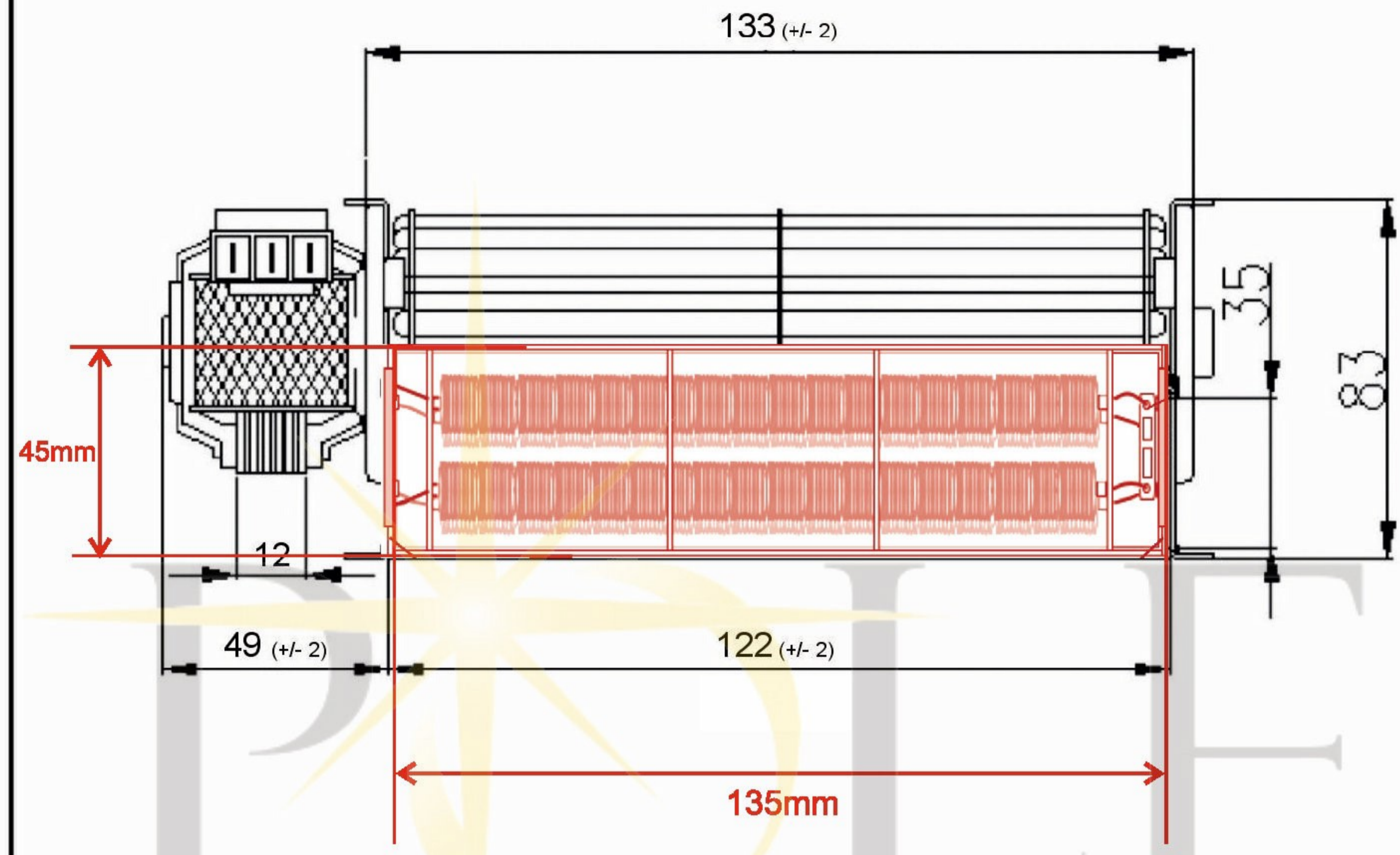
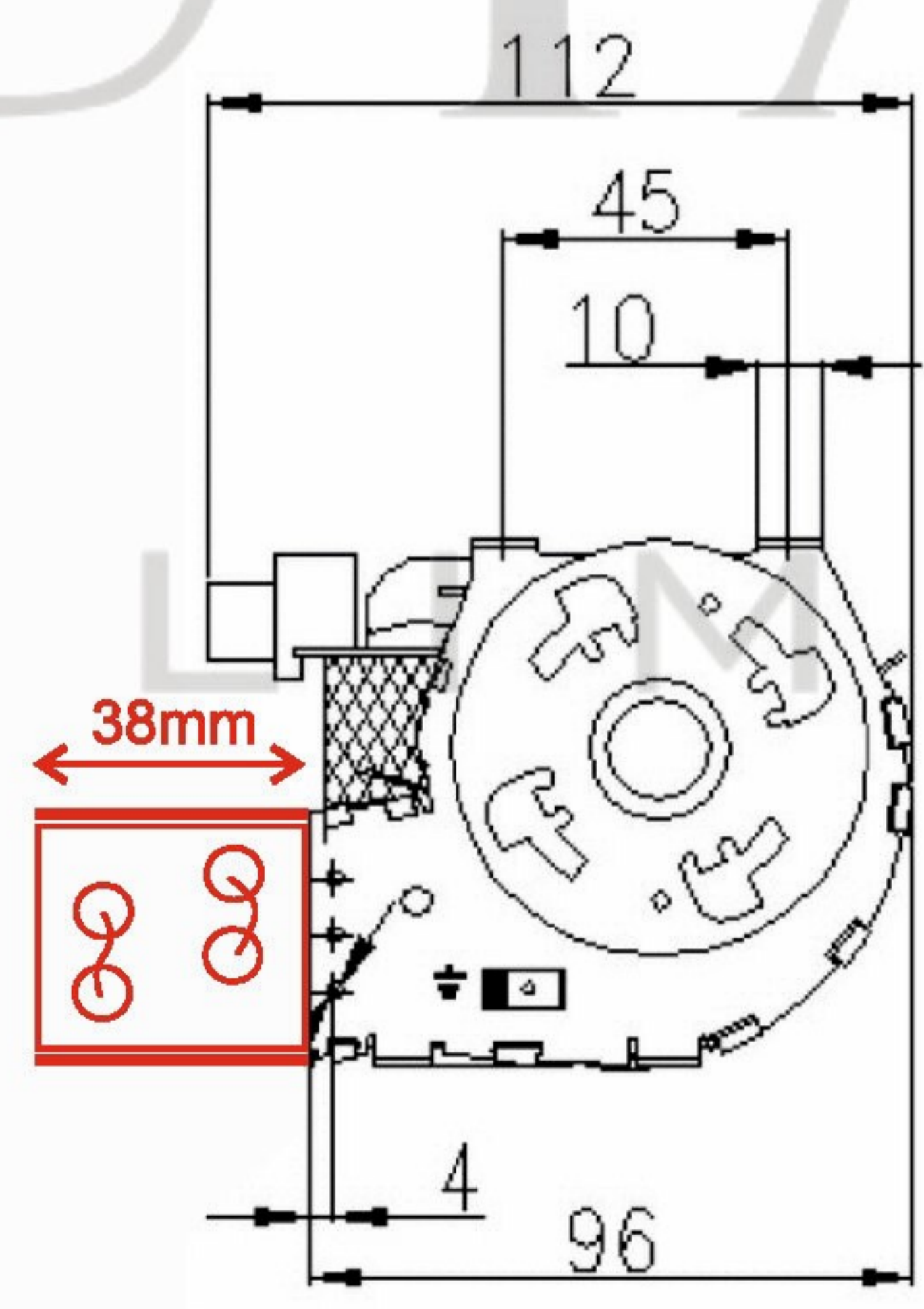
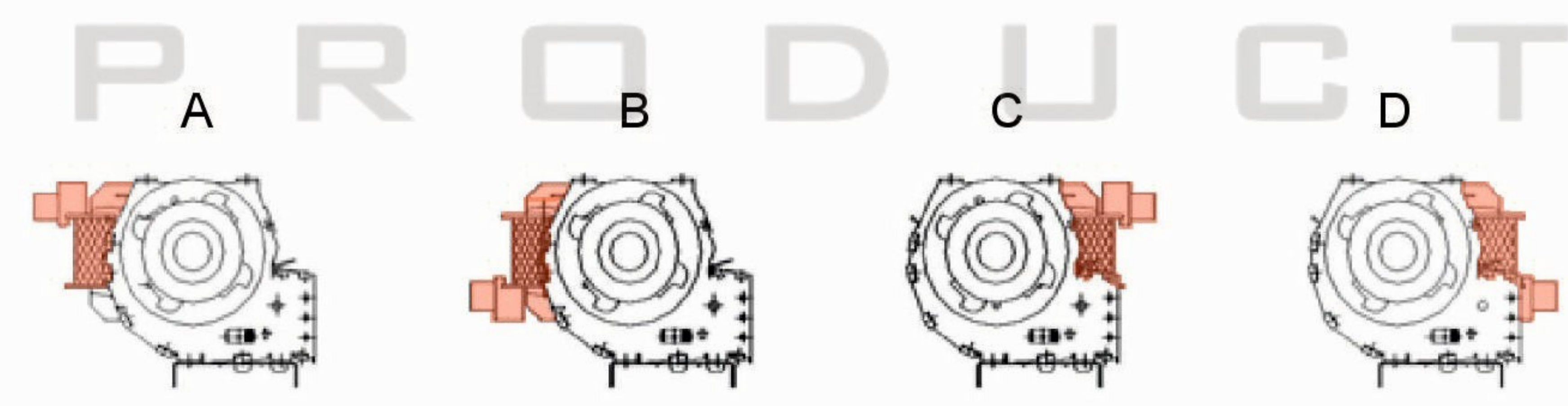

Heating element: 500+500 watts (1000w)

SPECIFICATION	Temp. Range: 0°C to + 60°C				
Motor	SHP	Speed (RPM)	1600	Bearings	Sleeve
Voltage (V)	230/240	Motor Protection	Imp.Prot	Weight (Kg)	0.8
Frequency (Hz)	50	Insulation Class	F	Air Volume (M³/h)	85
Power In/Out (W)	19	Protection Class	IP20	Noise Level (dBA)	
Current (A)		Capacitor (Mf)	N/A	Max Pressure (Pa)	57

POLE STAR
PRODUCTS LIMITED

POLE STAR PRODUCTS LIMITED	
Product Code	TAS12-HE-1A
Projection Angle ± 3°	A4 Scale: Sheet: 1 of